

Installation Instructions

Before you begin, please make sure all parts and proper quantities are included. Any parts damaged during shipment must be reported within 5 days of receipt. To report information regarding damages or if you have any questions, please call 800.242.2303.

Tools Required

- Drill
- Level
- Metal File

Parts List:

- Mounting Brackets



Step 1:

Snap mounting bracket to correct length for wall construction and file off any burrs or sharp corners that may be exposed if cabinet is moved. Mount the bracket to the wall so that the distance from the floor to the center of the screws is 25.5". (Installers should verify field dimensions as site circumstances may vary.)

Fasteners for mounting the bracket to the wall are to be supplied by the customer and should be appropriate for the wall construction.

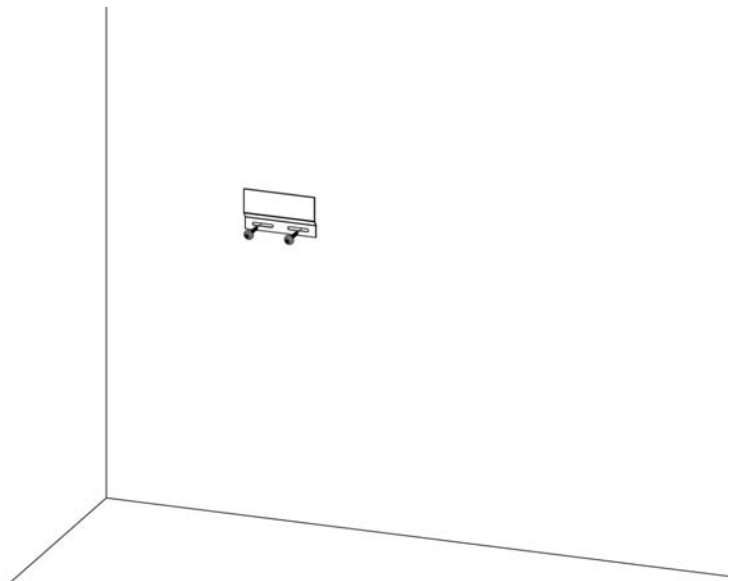

Step 2:

Once mounting bracket is properly fastened to the wall, slide the cabinet against the wall. (Actual cabinet may differ from image shown at right.)

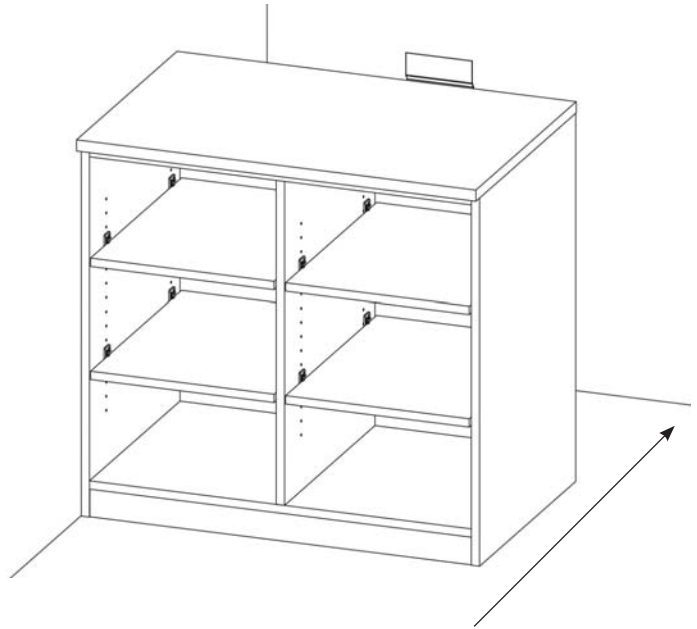

Step 3:

Turn handle to engage lock and to connect the cabinet to the wall.

