



©Greg Gent Studios 2016

# healthwork

BY WB MANUFACTURING  
premium healthcare casework

**WB** Mfg

Wisconsin Bench Manufacturing  
[wibenchmfg.com](http://wibenchmfg.com)

# Base Cabinets

**Model # HB1140**

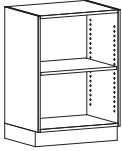

**Base Cabinet - Open**

W: 12, 15, 16, 18, 21, 24, 27, 30, 32, 33, 36"  
 H: 28.5, 32.5, 34.5"  
 D: 20, 24"  
 Open  
 1 Adjustable Shelf

**Model # HB1150**



**Base Cabinet - Open**

W: 12, 15, 16, 18, 21, 24, 27, 30, 32, 33, 36"  
 H: 28.5, 32.5, 34.5"  
 D: 20, 24"  
 Open, 2 Adjustable Shelves

**Model # HB2110/2120**

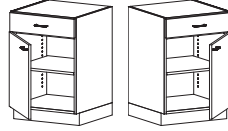

**Drawer Storage Base - Single Door**

W: 12, 15, 16, 18, 21, 24"  
 H: 28.5, 32.5, 34.5"  
 D: 20, 24"  
 Single Drawer Over Door  
 Left/Right Hinged  
 1 Adjustable Shelf

**Model # HB2300**

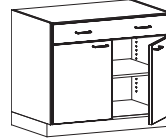

**Drawer Storage Base - Double Door w/Drawer**

W: 21, 24, 27, 30, 32, 33, 36"  
 H: 28.5, 32.5, 34.5"  
 D: 20, 24"  
 Single Drawer Over Double Door, 1 Adjustable Shelf

**Model # HB2400**



**Drawer Storage Base - Double Door/Drawer**

W: 24, 27, 30, 32, 33, 36, 39, 42, 45, 48"  
 H: 28.5, 32.5, 34.5"  
 D: 20, 24"  
 Double Drawer Over Double Door, 1 Adjustable Shelf

**Model # HB2510/2520**

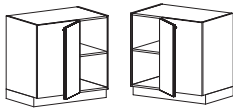

**Blind Corner Base Cabinet**

W: 36"  
 H: 28.5, 32.5, 34.5"  
 D: 20, 24"  
 Corner Base Left/Right Hinged  
 1 Fixed Shelf

**Model # HB3010/3015**

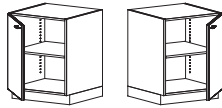

**Base Cabinet-Sgl Door**

W: 12, 15, 16, 18, 21, 24"  
 H: 28.5, 32.5, 34.5"  
 D: 20, 24"  
 Full Height Door  
 Left/Right Hinged  
 1 Adjustable Shelf

**Model # HB3050/3060**

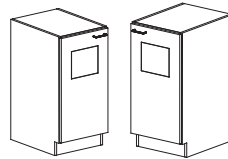

**Trash Door Cabinet**

W: 16, 18, 21, 24"  
 H: 28.5, 32.5, 34.5"  
 D: 20, 24"  
 8"x10" Top Hinged Trash Door

**Model # HB3112**

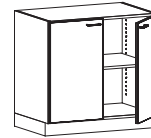

**Base Cabinet-DbL Door**

W: 21, 24, 27, 30, 32, 33, 36, 39, 42, 45, 48"  
 H: 28.5, 32.5, 34.5"  
 D: 20, 24"  
 Double Full Height Doors  
 1 Adjustable Shelf

**Model # HB4102**

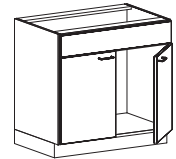

**Sink Base - DbL Door**

W: 21, 24, 27, 30, 32, 33, 36, 39, 42, 45, 48"  
 H: 28.5, 32.5, 34.5"  
 D: 20, 24"  
 Sink Base Double Doors

**Model # HB4110/4120**

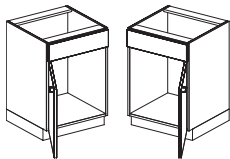

**Sink Base - Single Door**

W: 24"  
 H: 28.5, 32.5, 34.5"  
 D: 20, 24"  
 Sink Base  
 Left/Right Hinge

**Model # HB4400**

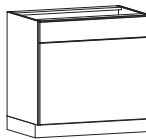

**Sink Base w/False Front**

W: 21, 24, 27, 30, 32, 33, 36, 39, 42, 45, 48"  
 H: 28.5, 32.5, 34.5"  
 D: 20, 24"  
 Sink Base w/ False Front

**Model # HB6020**



**Base - Double Drawer**

W: 32"  
 H: 28.5, 32.5, 34.5"  
 D: 20, 24"  
 2 Equal Drawers

**Model # HB6040**



**Drawer Base Cabinet - 4 Drawer**

W: 16, 18, 21, 24, 27, 30, 36"  
 H: 28.5, 32.5, 34.5"  
 D: 20, 24"  
 4 Equal Drawers

**Model # HB6070**



**Drawer Base Cabinet**

W: 15, 16, 18, 21, 24"  
 H: 28.5, 32.5, 34.5"  
 D: 20, 24"  
 2 Standard Drawers(6.125")  
 2 Equal Drawers

**Model # HB6075**

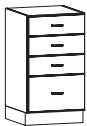

**Utility Drawer Base Cabinet**

W: 16, 18, 21, 24"  
 H: 32.5, 34.5"  
 D: 20, 24"  
 3 Standard Drawers(6.125")  
 1 Bottom Drawer depending on Height of Cabinet

**Model # HB9200**

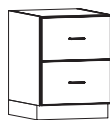

**File Base Cabinet**

W: 16, 18, 21"  
 H: 28.5"  
 D: 20, 24"  
 2 File Drawers

**Model # HB9205**



**File Base Cabinet**

W: 16, 18, 21"  
 H: 28.5, 32.5, 34.5"  
 D: 20, 24"  
 Top Drawer 6.125", Middle Drawer Depends on Height of Cabinet, Bottom is File Drawer

**Model # HB9310**



**Drawer File Base Cabinet**

W: 16, 18, 21"  
 H: 34.5"  
 D: 20, 24"  
 1 Standard Drawer (6.125")  
 2 File Drawers

# Wall Cabinets

# Tall Cabinets

**Model # HW1180**

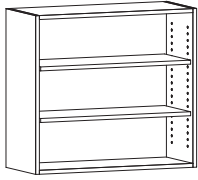

**Wall Cabinet - Open**

W: 12, 15, 16, 18, 21, 24, 27, 30, 32, 33, 36, 39, 42, 45, 48"  
H: 18, 21, 24, 27, 30, 33, 36, 39, 42, 45, 48"  
D: 14"

**Model # HW2110/2120**

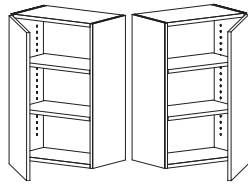

**Wall Cabinet - Sgl Door**

W: 12, 15, 16, 18, 21, 24"  
H: 18, 24, 30, 36, 40, 42, 48"  
D: 14"  
Single Door Left/Right Hinge

**Model # HW2182**

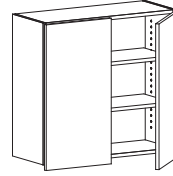

**Wall Cabinet - Dbl Door**

W: 21, 24, 27, 30, 32, 33, 36, 39, 42, 45, 48"  
H: 18, 24, 36, 40, 42, 48"  
D: 14"  
Double Door

**Model # H1T**

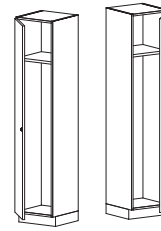

**Locker - Single Door**

W: 12"  
H: 75"  
D: 18"  
Locker, One Fixed Shelf, Two Interior Coat Hooks

**Model # H2T**

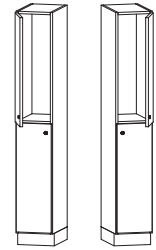

**Locker - Double Door**

W: 12"  
H: 75"  
D: 18"  
Locker, Double Door

**Model # H4T**

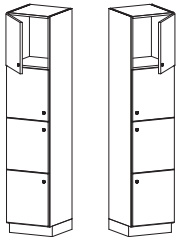

**Locker - Quad Door**

W: 12"  
H: 75"  
D: 18"  
Locker, Quad Door

**Model # HT1250**

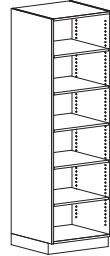

**Tall Storage Cabinet - Open**

W: 12, 15, 16, 18, 21, 24, 27, 30, 32, 33, 36, 39, 42, 45, 48"  
H: 65, 84"  
D: 14, 20, 24"  
Open Storage Unit, One Fixed Shelf

**Model # HT3210/3220**

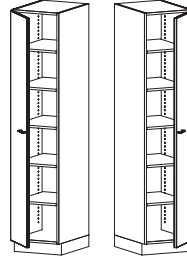

**Tall Storage Cabinet - Single Door**

W: 12, 15, 16, 18, 21, 24"  
H: 65, 84"  
D: 14, 20, 24"  
Single Door, Left/Right Hinge, 1 Fixed Shelf, 2/4 Adjustable Shelves

**Model # HT3232**

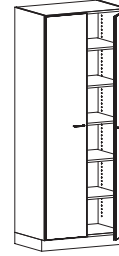

**Tall Storage Cabinet - Double Door**

W: 21, 24, 27, 30, 32, 33, 36, 39, 42, 45, 48"  
H: 65, 84"  
D: 14, 20, 24"  
Double Doors, 1 Fixed Shelf, 2/4 Adjustable Shelves

**Model # HT4110/4120**



**Tall Wardrobe Cabinet - Single Door**

W: 15, 16, 18, 21, 24"  
H: 65, 84"  
D: 24"  
Single Door Wardrobe, Left/Right Hinge, 1 Fixed Shelf, 1 Clothing Rod

**Model # HT4122**

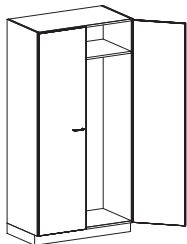

**Tall Wardrobe Cabinet - Double Door**

W: 24, 27, 30, 32, 33, 36"  
H: 65, 84"  
D: 24"  
Double Door Wardrobe  
1 Fixed Shelf  
1 Clothing Rod



# Speciality Cabinets

Model # HMS361436



**Mail Storage Cabinet**

W: 32, 36"  
H: 36, 40"  
D: 14"  
Mail Storage  
Bin Openings, 9.625"W,  
Varying Height. x 12" D

Model # HWFH10/20

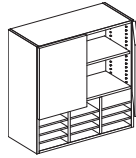

**Form Holder Cabinet -  
Double Door**

W: 32"  
H: 36, 40"  
D: 14"  
Double Drs w/1 Adj. Shelf,  
12 Opening (9.625") Each,  
Varying Height. x 12" D

Model # HW2430

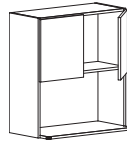

**Microwave Cabinet -  
Double Door**

W: 32"  
H: 36, 40"  
D: 14"  
Microwave cabinet, Double  
Doors, One Adjustable Shelf

Model # HB8300



**Linen Cabinet**

W: 30, 32, 33, 36"  
H: 28.5, 32.5, 34.5"  
D: 24"  
Linen Cabinet

Model # HD8110



**Prescription Desk -  
Wall Mounted**

W: 34"  
H: 17"  
D: 16"  
Wall Prescription Desk  
With Drawer

Model # HD8120

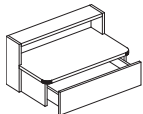

**Prescription Desk**

W: 34"  
H: 11"  
D: 17"  
Prescription Desk With Drawer

Model # HT1224

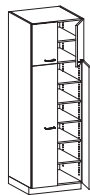

**Specialty Storage  
Cabinet**

W: 15, 16, 18, 21, 24"  
H: 93"  
D: 24"  
Specialty Storage  
Split Double Doors

Model # HT1234



**Specialty Storage  
Cabinet - Open**

W: 15, 16, 18, 21, 24"  
H: 93"  
D: 24"  
Specialty Storage/ Open  
Split Double Doors

# We Can. DESIGN. BUILD. DELIVER.

WB (Wisconsin Bench) Manufacturing can **Design** the solutions to meet your environment. Choose from our vast array of furniture and cabinet standards or talk directly to our in-house design team to customize products to fit your space.

We can **Build** it. With over 100 skilled American workforce professionals in our plant in Thorp WI, WB Manufacturing can build what you need when you need it. Utilizing quality materials and processes to ensure affordable, durable, long lasting products backed by a comprehensive warranty.



We can **Deliver**. Yes, we can facilitate timely, affordable shipment of your products, but we also "deliver". Deliver the best product, the best customer service and the best solutions for what we hope is the best experience one can have when fulfilling your educational, office, health care and industrial needs. At WB Manufacturing...**We Can**.

# Healthwork - Healthcare Overview

- Case: Fully doweled 0.75" cabinet, full sub top, inset back
- Countertop: High pressure laminate (HPL) with 0.75" backsplash up to 144"L (sold separately, field installed)
- Drawers: Fully doweled 0.75" drawer box with 0.75" front, wire pull standard
- Drawer Glides: Standard full extension side mount glides and file management systems on designated drawers
- Doors: 0.75" doors, wire pull standard on bases, 1" door projection below cabinet standard on uppers
- Hinges: 6-point adjustable concealed hinge, 120°
- Shelves: 0.75" shelf sealed on all sides (shelf is supported with Sekura pins)
- Finish: Decorative HPL on door and drawer fronts, fully finished matching thermal fused laminate (TFL) case and drawer boxes
- Edge Banding: Fully sealed with 0.5mm PVC edge banding on exposed and semi-exposed sides, 1.4mm PVC on doors, drawer fronts and countertop
- Base: 0.75" exterior grade plywood ladder, applied base (vinyl baseboard not included), or fabricated without base



3/4" fully doweled casebody construction



HPL countertop (sold separately)



1" door projection (standard on uppers)



Wire pull (standard on bases)



6-point adjustable hinge (standard)



Full extension side mount drawer glide (standard)



Ladder or applied plywood base (optional)



3/4" shelves sealed completely on all sides



0.5mm PVC casebody matching edge banding



1.4mm PVC door and drawer matching edge banding



Integrated single or gang locks (optional)



File drawer system (standard on file drawers)

## HPL & TFL Standard Laminate Color Options



WB Solar Oak\* (-DX)



WB Honey Maple\* (-FV)



WB Oiled Cherry\* (-SR)



WB American Cherry\* (-Z09)



WB Chestnut Woodline\* (-A24)



WB Black\* (-09)



WB Hardrock Maple\* (-HM)



WB Folkstone\* (-FS)



WB Antique White\* (-HJ)

\*Stocked in limited sizes & quantities. Contact Customer Service for lead time.





507 E. Grant St.  
Thorp, WI 54771  
P - 800.242.2303  
F - 715.669.5929  
[wibenchmfg.com](http://wibenchmfg.com)



## Premium Healthcare Casework

Standard and Custom Solutions

In recent years, WB Manufacturing has been called upon by leaders in the industry to bring its quality products, on-time delivery and competitive pricing to the healthcare market. Working directly with healthcare professionals, WB Manufacturing has developed Healthwork premium healthcare casework.

Whether in patient or exam rooms, assisted living or long-term care facilities, nursing or reception stations, WB Manufacturing can design, build and deliver healthcare casework and furniture with the functionality and style to meet your facilities needs. Limited Lifetime warranty.

**We Can.**  
**DESIGN. BUILD. DELIVER.**

