

Construction:

Unit is constructed using .75" thick particle board with thermal fused laminate on both sides with TFL top over subtop. Doors, drawers and top edges are finished using 3mm PVC edge banding. Double-sided adjustable shelves have four double pin shelf clips per shelf to prevent the shelves from sliding out or tipping. Each unit has built-in corner levelers which are accessible from the inside for easy leveling of the unit. Optional hidden casters are available. 6-point adjustable concealed European hinge with 120 degree opening. 4" Wire pull style handles and integrated design locks.

Whiteboards:

Aluminum horizontal sliding panel system with two whiteboards standard, optional third whiteboard. Porcelain-on-steel marker surface guarantees a durable, high-performance board. Marker board frame constructed of anodized aluminum trim and includes a cork map rail. Magnetic panels glide on nylon rollers for smooth operation. Finger pull for easy operation and tray for markers.

Assembly:

Each unit is factory assembled using dowel construction. Field assembly of entire unit to include installation of the board and rail system.

Shipping Class:

Density Based Class

iXchange Learning Wall Model Numbers:

Model #	W" x D" x H"	Weight
SSW0801	96" x 24" x 84"	1110
SSW0802	96" x 24" x 84"	1085
SSW1001	120" x 24" x 84"	1270
SSW1002	120" x 24" x 84"	1360
SSW1201	144" x 24" x 84"	1550
SSW1202	144" x 24" x 84"	1575
SSW1203	144" x 24" x 84"	1585

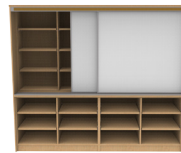

SSW0801



SSW0802



SSW1001



SSW1002



SSW1201



SSW1202

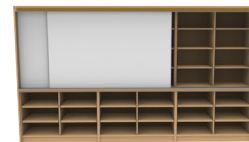

SSW1203



SSW0802



Shelves and double-pin clips



Built-in leveler and optional hidden caster

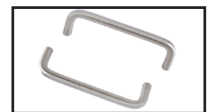

4" Wire Pulls